

IMC-7211/723

Slide-In Modular Media Converter T1/E1/J1 and DS3/E3/STS Series



Features

- DIP switch selectable protocols
- Supports Alarm Indication Signals (AIS)
- Supports Remote Alarm Indications (RAI) (IMC-7211)
- Supports Link Fault Pass Through (LFPT) (IMC-7211.E1MUX)

Introduction

The IMC-7211 series converts 1.544Mbps T1/J1 and 2.048Mbps E1 traffic from conventional copper-based interfaces over regular fiber optics for long distance transmission up to 80km. The IMC-7211-T1MUX and IMC-7211-E1MUX are double wide media converters for the IMC-71x chassis series that transports four independent T1 lines over a single or dual fiber optic line. They support a full bandwidth 10/100BaseT Ethernet connection over the same optical link. The fiber redundancy (1+1) functionality on removable SFP modules offers the enhanced reliability of a protected fiber link while supporting the complete range of optical types and distances. They also feature an independent serial link (RS-232) which is useful for local monitoring and configuration of the unit by technical support personnel.

The IMC-723 series enables users to convert coaxial media to single-mode fiber and extend the distance of data transmissions over access networks up to 40km. The series supports premise networking applications to convert the incoming circuit to fiber for distribution into the structured cabling system.

The IMC-720 series are installed as a host-remote pair and can be remotely managed when the host is installed in an IMC-713/716/719 series with an SNMP management module. Since IMC-700 media converter series management technology functions transparently to the user data, real-time and end-to-end management is provided at all times.

Specifications

Technical	
T1/J1 1.544 Mbps, E1 2.048 Mbps (IMC-7211 series)	
Four independent E1 ports on RJ-48 (IMC-7211-T1/E1MUX)	
DS3 45 Mbps, E3 34 Mbps or STS-1 52 Mbps (IMC-723)	
Configuration Control (IMC-7211 series)	
Link Fault Pass-Through (LFPT) (IMC-7211-T1/E1MUX)	
Supports Dying GASP (IMC-7211-T1/E1MUX)	
Supports LinkLoss and FiberAlert	
Supports GUI-Based iView ²	
Supports Diagnostic LEDs	
Includes Hot-swappable Architecture	
Dual SFP fiber ports (IMC-721-T1/E1MUX)	
Meantime Before Failure (MTBF)	
MTBF	2,000,000 hours (IMC-7211 series)
	732,333 hours (IMC-7211-T1/E1MUX)
	433,422 hours (IMC-723 series)

Environment	
Operating Temperature	0 to +50 °C (+32 to +122 °F) (IMC-7211/723 series)
	0 to +70 °C (+32 to +160 °F) (IMC-7211-T1/E1MUX)
Storage Temperature	-25 to +70 °C (-13 to +158 °F) (IMC-7211/723 series)
	-40 to +70 °C (-40 to +158 °F) (IMC-7211-T1/E1MUX)
Operating Humidity	5 ~ 95% (non-condensing)
	0 ~ 10,000 ft. altitude
Mechanical	
Dimensions (H x W x D)	10.74 x 2.0 x 7.05 cm (4.19 x 0.78 x 2.75 in)
	Double-wide (IMC-7211-T1/E1MUX)
Weight	0.11 kg (0.30 lb) (IMC-7211 & IMC-723 series)
	0.50 kg (1.1 lb) (IMC-7211-T1/E1MUX)
Certifications	
CE, FCC Class A, UL/cUL, CSA (IMC-7211 series)	
CE, FCC Class B (IMC-7211-T1/E1MUX & IMC-723 series)	

* Simple Network Management Protocol-based element management software. To configure, update, manage and monitor from a central location.



iView2: Webserver version, available for download from website.

Dimensions

Unit: mm

IMC-721I Series

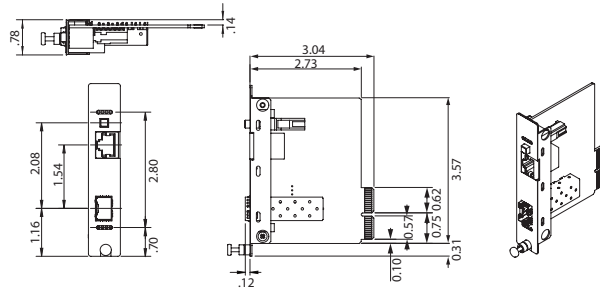

IMC-721I T1/E1 MUX

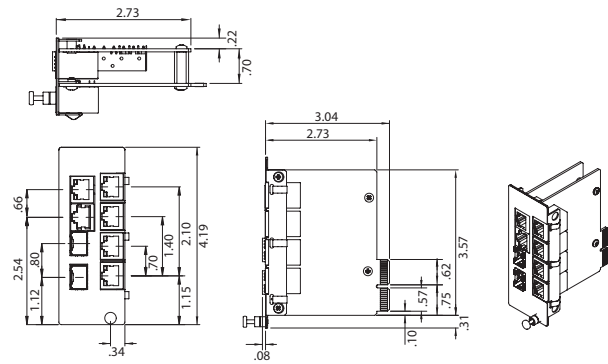

IMC-723 Series

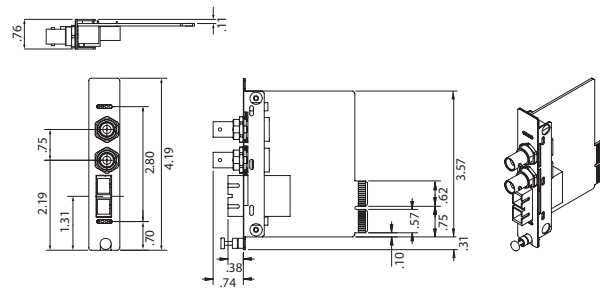

Ordering Information

Part Number	Also Known As	Optical Speed	Optical Mode	Wavelength	Distance	Optical Connector
IMC-721I-MMST	850-18103	100 Mbps	Multi-Mode	1300 nm	5 km	1 x ST
IMC-721I-MM	850-18104	100 Mbps	Multi-Mode	1300 nm	5 km	1 x SC
IMC-721I-SEST	850-18105	100 Mbps	Single-Mode	1310 nm	40 km	1 x ST
IMC-721I-SE	850-18106	100 Mbps	Single-Mode	1310 nm	40 km	1 x SC
IMC-721I-SL	850-18108	100 Mbps	Single-Mode	1310 nm	80 km	1 x SC
IMC-721I-SST	850-18122	100 Mbps	Single-Strand	1310T/1550R	20 km	1 x SC
IMC-721I-SSR	850-18123	100 Mbps	Single-Strand	1550T/1310R	20 km	1 x SC
IMC-721I-SSET	850-18124	100 Mbps	Single-Strand	1310T/1550R	40 km	1 x SC
IMC-721I-SSER	850-18125	100 Mbps	Single-Strand	1550T/1310R	40 km	1 x SC
IMC-721I-SFP	850-18100	100 Mbps	Various	Various	Various	1 x SFP
IMC-721I-T1MUX	857-18110	100 Mbps	Various	Various	Various	2 x SFP
IMC-721I-E1MUX	857-18111	100 Mbps	Various	Various	Various	2 x SFP
IMC-723-SE	850-14403	100 Mbps	Single-Mode	1310 nm	40 km	1 x SC
IMC-723-SSET	850-14412	100 Mbps	Single-Strand	1310T/1550R	40 km	1 x SC
IMC-723-SSER	850-14413	100 Mbps	Single-Strand	1550T/1310R	40 km	1 x SC

* SFP fibers sold separately – available at www.advantech.com

Accessories

Part Number	Description
825-39951	Serial Cable, MiniJack to DB9 (female) (IMC-721I-T1/E1MUX)

Tento produkt můžete zakoupit u společnosti AutoCont IPC a.s.



AutoCont IPC a.s.

Váš dodavatel průmyslových počítačů, komponent a speciálních průmyslových IT systémů.

 Uhlířská 1064/3, 710 00 Ostrava, Česká republika

 obchod@autocont-ipc.cz

 +420 552 301 002

 www.autocont-ipc.cz



PRŮMYSLOVÉ POČÍTAČE

fanless embedded PC, do racku, ...



POČÍTAČE S DISPLEJEM

panelové PC, terminály, do vozidel, ...



AUTOMATIZACE A SBĚR DAT

převodníky, karty, moduly, switche, ...



PERIFERIE A KOMPONENTY

monitory, klávesnice, desky, skříně, ...



NOTEBOOKY A TABLETY

odolné, windows, android, IP65, ...



INFORMAČNÍ KIOSKY

interiérové, venkovní, ...



MEDICÍNSKÁ TECHNIKA

počítače, tablety, LCD, klávesnice, ...



SOFTWAREVÁ ŘEŠENÍ

pro výrobu, zaměstnance, kiosky, ...



PŘEJÍT DO E-SHOPU

eshop.autocont-ipc.cz



DOPRAVA ZDARMA

Doprava zdarma v ČR a SR při objednávce nad 10 000 Kč bez DPH nebo nad 400 EUR.



PRODLOUŽENÁ ZÁRUKA

Záruka 2 roky na vyráběné počítače s možností jejího prodloužení až na 5 let.



ODMĚNA ZA VĚRNOST

Pravidelní zákazníci u nás nakupují za nižší ceny. Výše slevy se odvíjí od realizovaného obrátu.



SERVIS ON-SITE A IN-TIME

K projektovým dodávkám nabízíme rozšířenou podporu a servis s garancí výměny zařízení do 48 hodin.