

UNO-3382G

UNO-3384G

Intel® Core™ i7/Celeron® Control Cabinet PC w/ 2 x GbE, 2 x mPCIe, HDMI/DP

NEW



Features

- 4th generation Intel® Core™ i7/Celeron® processors with 8GB/4GB DDR3L memory
- 2 x GbE, 2 x USB 2.0, 2 x USB 3.0, 1 x RS-232/RS-422/485, 1 x HDMI, 1 x DP, 1 x CFast, 2 x PCI/PCIe, 2 x mPCIe (2 x full)
- Hot-swappable HDD/SSD support for RAID 0/1
- Protection Technology of optional UPS is compatible with UNO-3300 series which enhances the quality of input power and secure the data safety
- Supports Fieldbus protocol by iDoor technology 3G/GPS/GPRS/Wi-Fi communication by iDoor technology
- Supports MRAM by iDoor technology
- LAN redundancy (teaming)

Introduction

Advantech's UNO-3300 series offer an open and universal automation solution. The newest UNO-3300 series of the Control Cabinet PC have attractive and flexible extension capabilities such as 2 x USB 2.0 ports and 2 x USB 3.0 ports, 1 x HDMI, 1 x DP, 1 x CFast, 1 x COM ports, 2 x LANS, 2 x mPCIe and 2 x PCI/PCIe. It's a reliable industrial control machine certified by industrial automation standard IEC-61010.

Specifications

General

- **Certification** CE, FCC, UL
- **Dimensions (W x D x H)** UNO-3382G: 65.2 x 254 x 207 mm (2.5" x 10" x 8.15")
UNO-3384G: 103.2 x 254 x 207 mm (4.06" x 10" x 8.15")
- **Form Factor** Regular Size
- **Enclosure** Aluminum Housing
- **Mounting** Book mounting
- **Weight (Net)** UNO-3382G: 3.1kg
UNO-3384G: 3.9kg
- **Power Requirements** 24 V_{DC} ± 20%
- **Power Consumption** 45W (Typical), 65W (Max, UNO-3382),
75W (Max, UNO-3384)
- **OS Support** WIN7/8, WES7, WES10, Advantech Linux

System Hardware

- **BIOS** AMI UEFI 128Mbit Flash BIOS
- **Watchdog Timer** Programmable 255 levels timer interval, from 1 to 255 sec
- **Processor** Intel® Core™ i7-4650U 1.7GHz Haswell, 4MB L2
Intel® Celeron® 2980U 1.6GHz, 2MB L2
- **System Chip** Integrated Intel 8 Series Chipset
- **Memory** Built-in 4GB/8GB DDR3L 1333 MHz
- **Graphics Engine** Intel® HD graphics
- **Ethernet** Intel® i210-ITGbE
- **LED Indicators** LEDs for Power, Battery, COM (Tx/Rx) HDD and reserved x 2
- **Storage** 1 x CFast slot
Two built-in 2.5" SATA HDD brackets with support for RAID 0/1. (Compatible with 9.5mm height HDD)
- **Expansion** UNO-3382G: 2 Full-size mPCIe
UNO-3384G: 2 Full-size mPCIe, 1x PCIe4, 1x PCI
(total combined power consumption on the PCI/PCIe slots should be less than 20W)

I/O Interfaces

- **Serial Ports** 1 x RS-232/422/485, DB9, auto flow control, 50-115.2kbps
- **LAN Ports** 2 x RJ45, 10/100/1000 Mbps IEEE 802.3u 1000BASE-T Fast Ethernet
- **USB Ports** 4 x USB Ports (2 x USB 2.0, 2 x USB 3.0 compliant)
- **Displays** 1 x HDMI, supports 1920 x 1200 @ 60Hz 24bpp
1 x DP, supports 3200 x 2000 @ 60Hz 24bpp
- **Power Connector** 1 x 3 Pin, Terminal Block

Environment

- **Operating Temperature** 0 ~ 55°C (32 ~ 131°F) @ 5 ~ 85% RH with 0.7m/s airflow (Industry SSD)
- **Storage Temperature** -40 ~ 85°C (-40 ~ 185°F)
- **Relative Humidity** 10 ~ 95% RH @ 40°C, non-condensing
- **Shock Protection** Operating, IEC 60068-2-27, 20G, half sine, 11ms
- **Vibration Protection** Operating, IEC 60068-2-64, 2Grms, random, 5 ~ 500Hz, 1hr/axis (mSATA)

Installation Scenario

Book mounting

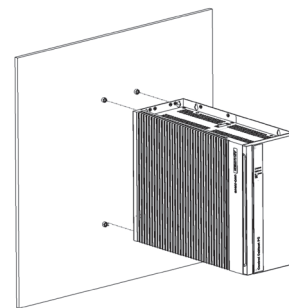

Wall mount

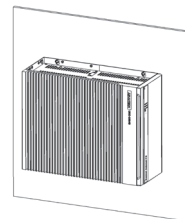

Dimensions

Unit: mm

UNO-3382G

UNO-3384G

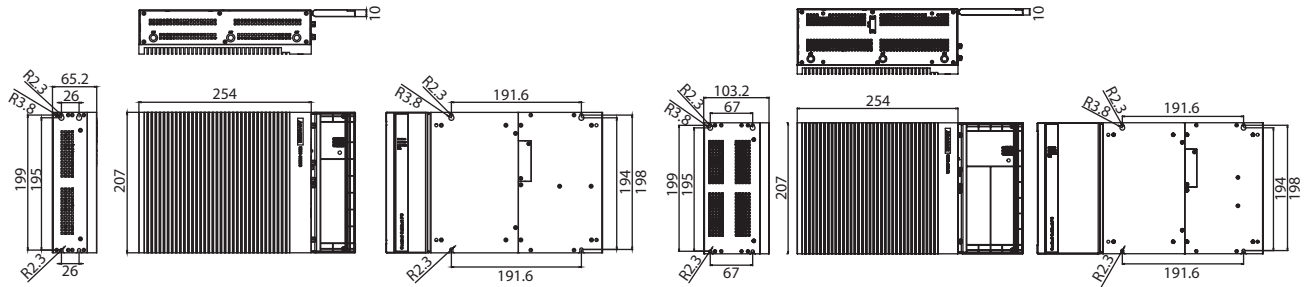

I/O View

UNO-3384G

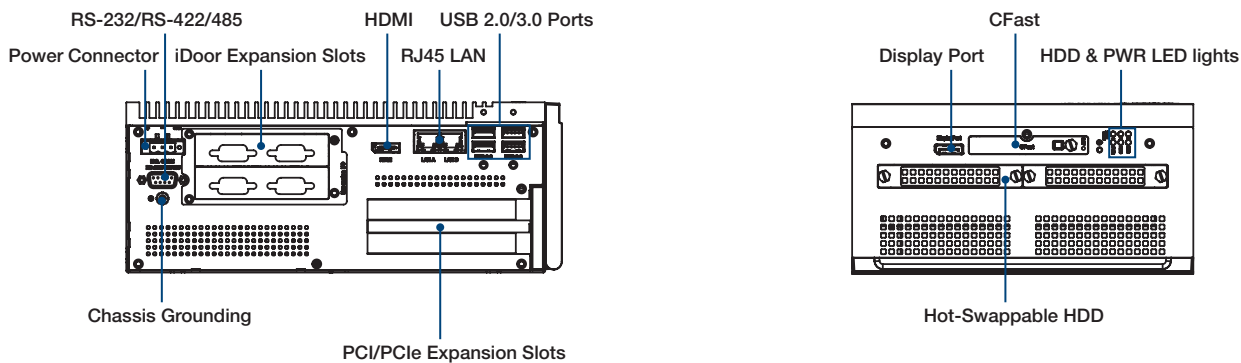

Ordering Information

- **UNO-3382G-474AE** Intel® Core™ i7-4650U 1.7GHz, 8GB, 2 x LANs, 2 x Full-size mPCIe, 1 x HDMI, 1 x DP
- **UNO-3384G-474AE** Intel® Core™ i7-4650U 1.7GHz, 8GB, 2 x LANs, 1 x PCIe4, 1 x PCI, 2 x Full-size mPCIe, 1 x HDMI, 1 x DP
- **UNO-3382G-4C3AE** Intel® Celeron® 2980U 1.6GHz, 4GB, 2 x LANs, 2 x Full-size mPCIe, 1 x HDMI, 1 x DP
- **UNO-3384G-4C3AE** Intel® Celeron® 2980U 1.6GHz, 4GB, 2 x LANs, 1 x PCIe4, 1 x PCI, 2 x Full-size mPCIe, 1 x HDMI, 1 x DP

Optional Accessories

- **UNO-IPS2730-AE** UPS module
- **UNO-3300FAN-AE** FAN kit for UNO-3384G series
- **96PSA-A150W24T2** 150W AC to DC power adapter
- **1702002600** Power Cable US Plug 1.8 M
- **1702002605** Power Cable EU Plug 1.8 M
- **1702031801** Power Cable UK Plug 1.8 M
- **1700000596** Power Cable China/Australia Plug 1.8 M

Embedded O/S

- **2070013477** Image WES7P X64 MUI. for UNO-3382G/3384G
- **2070013478** Image Linux for UNO-3382G/3384G

iDoor Modules

- **PCM-24R2PE-AE** Intel i350, GbE, PoE IEEE 802.3af, PD, RJ45 x 2
- **PCM-24S2WF-BE** 802.11 a/b/g/n/ac 2T2R w/BT4.1, Atheros QCA6174A
- **PCM-26D2CA-AE** SJA1000 CANbus, CANopen, DB9 x 1
- **PCM-24D2R4-BE** 2-Ports Isolated RS-422/485 mPCIe, DB9
- **PCM-24D2R2-BE** 2-Ports Isolated RS-232 mPCIe, DB9
- **PCM-24D4R4-BE** 4-Ports Non-Isolated RS-422/485 mPCIe, DB37
- **PCM-24D4R2-BE** 4-Ports Non-Isolated RS-232 mPCIe, DB37
- **PCM-27D24DI-AE** 24-Channels Isolated Digital I/O with counter mPCIe, DB37
- **PCM-24R1TP-AE** 1-Port Gigabit Ethernet, Intel® 82574L, mPCIe, RJ45

Tento produkt můžete zakoupit u společnosti AutoCont IPC a.s.



AutoCont IPC a.s.

Váš dodavatel průmyslových počítačů, komponent a speciálních průmyslových IT systémů.

 Uhlířská 1064/3, 710 00 Ostrava, Česká republika

 obchod@autocont-ipc.cz

 +420 552 301 002

 www.autocont-ipc.cz



PRŮMYSLOVÉ POČÍTAČE

fanless embedded PC, do racku, ...



POČÍTAČE S DISPLEJEM

panelové PC, terminály, do vozidel, ...



AUTOMATIZACE A SBĚR DAT

převodníky, karty, moduly, switche, ...



PERIFERIE A KOMPONENTY

monitory, klávesnice, desky, skříně, ...



NOTEBOOKY A TABLETY

odolné, windows, android, IP65, ...



INFORMAČNÍ KIOSKY

interiérové, venkovní, ...



MEDICÍNSKÁ TECHNIKA

počítače, tablety, LCD, klávesnice, ...



SOFTWAREVÁ ŘEŠENÍ

pro výrobu, zaměstnance, kiosky, ...



PŘEJÍT DO E-SHOPU

eshop.autocont-ipc.cz



DOPRAVA ZDARMA

Doprava zdarma v ČR a SR při objednávce nad 10 000 Kč bez DPH nebo nad 400 EUR.



PRODLOUŽENÁ ZÁRUKA

Záruka 2 roky na vyráběné počítače s možností jejího prodloužení až na 5 let.



ODMĚNA ZA VĚRNOST

Pravidelní zákazníci u nás nakupují za nižší ceny. Výše slevy se odvíjí od realizovaného obrátu.



SERVIS ON-SITE A IN-TIME

K projektovým dodávkám nabízíme rozšířenou podporu a servis s garancí výměny zařízení do 48 hodin.